

# TURBOCHEF

C3  
Electric  
Rapid Cook Microwave Oven



## ACCESSORIES (ADDITIONAL CHARGE)

- Oven Stands with locking casters
  - 17" (431.8mm) stainless steel with casters for stacked units
  - 24" (609.6mm) stainless steel with casters for single units

Project \_\_\_\_\_

Item No. \_\_\_\_\_

Quantity \_\_\_\_\_



**Standard depth baking compartment -**

**All data is shown per oven section, unless otherwise indicated.**

## SOFTWARE VERSIONS

- C3 *Professional* - simplified interface. Non-programmable
- C3 *Smart* - intuitive control with built-in cooking profiles. Programmable
- C3 *Custom* - customer / item specific menu programs developed with TurboChef Technologies Inc.

## EXTERIOR CONSTRUCTION

- 430 stainless steel front, top, sides and back
- 4" (101.6mm) chrome plated adjustable legs
- Powder coated handle
- Cool to the touch pull down door with microwave seal

## INTERIOR CONSTRUCTION

- Fully insulated cooking chamber
- 304 stainless steel liner with large radius corners
- Removable ceramic cooking platter with molded product standoffs
- Removable waveguide cap
- 304 stainless steel removable grease collection pan

## OPERATION

- Forced vertical recirculated convection hot air system
- Bottom launched microwave system
- Variable speed blower motor
- Two control compartment cooling fans
- Fully programmable control panel with touchpad interface capable of storing up to 64 product cooking profiles
- Self diagnostic control
- RS232 communication port provides direct computer access to update menu selections and change product information
- Catalytic converter eliminates flavor transfer between foods and reduces emissions / qualifies for ventless operation

## STANDARD FEATURES

- Two cooking platters
- Two waveguide caps
- One year parts and labor oven warranty\*

\* For all international markets contact your local distributor



## US ADDRESS

TURBOCHEF TECHNOLOGIES INC  
10500 Metric Drive, Suite 128, Dallas, TX, 75243  
Phone: (214) 379-6000 · Fax: (214) 379-6073

WWW.TURBOCHEF.COM

# TURBOCHEF

WWW.TURBOCHEF.COM



## C3



APPROVAL/STAMP

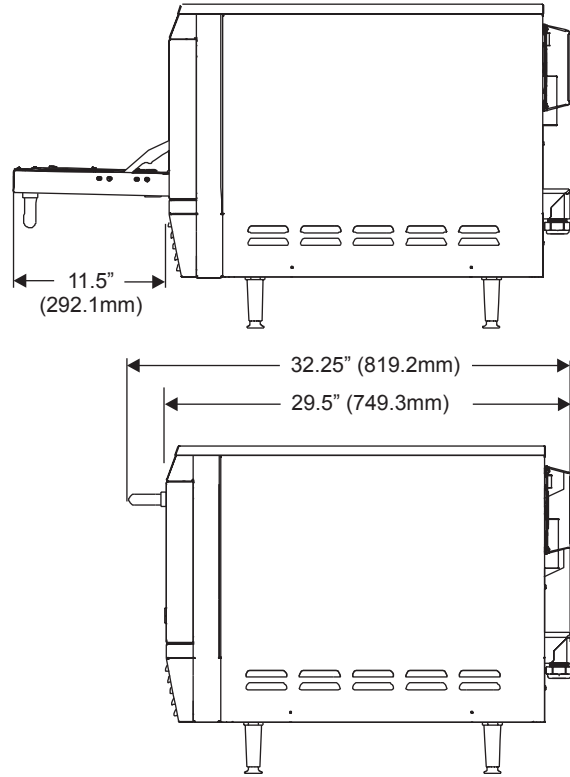
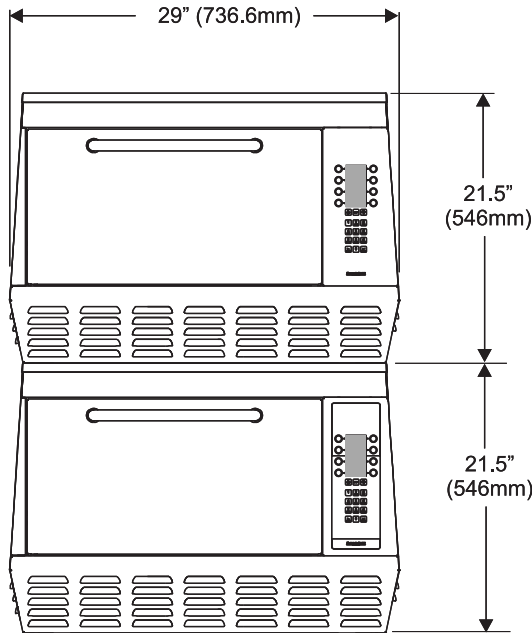

### SHORT TERM SPECIFICATIONS

Each TurboChef electric combination convection/microwave oven model C3 (single or double stacked) shall provide the following features and/or functions : Each compartment shall have 304 stainless steel liner with radius corners and shall accept one microwaveable cooking platter. Stainless steel front, top, sides and back. Door shall be of 430 stainless steel with powder coated cool grip handle. Unit shall be electrically heated and utilize dual cooking mediums (vertical forced hot air convection and bottom launched microwave). Forced convection air to be recirculated by means of a variable speed blower motor. Includes removable ceramic cooking platter with molded product standoffs. Fully programmable, self diagnostic control panel with touchpad interface capable of storing 64 product cooking profiles.

### DIMENSIONS:

<b>Floor space</b>	29" W x 32.25" D (736.6 x 819.2mm)
<b>Height</b>	
Unit Only	21.38" (543.1mm)
Single on Legs	25.38" (644.7mm)
Single on Stand	45.88" (1165.4mm)
Single on Cart	45.38" (1152.7mm)
Double on Legs	46.76" (1187.7mm)
Double on Stand	62.26" (1581.4mm)
Double on Cart	59.76" (1517.9mm)
Cavity	7.13" H x 17.81" W x 14.5" D (181.1 x 452.4 x 36mm)
Volume	1.06 cu ft

### WALL CLEARANCES:

Back	2" (50.8mm)
Sides	2" (50.8mm)

### MINIMUM ENTRY CLEARANCE:

Uncrated	25.38" (644.7mm)
Crated	30.5" (775mm)

NOTE: The company reserves the right to make substitutions of components or change specifications without prior notice.

TURBOCHEF TECHNOLOGIES INC  
10500 Metric Drive, Suite 128, Dallas, TX, 75243  
Phone: (214) 379-6000 · Fax: (214) 379-6073

Printed in U.S.A.

### POWER SUPPLY:

#### USA:

- 208/240, 60Hz, 1 Phase, 35/30 Amp, 3 wire (including ground)  
\* Connector: **NEMA 6-50P** installed on 6' cord

- 208, 60Hz, 1 Phase, 30 Amp, 3 wire (including ground)  
\* Connector: **Nema L6-30P** installed on 6' cord

#### INTERNATIONAL:

- 230-240 VAC, 1 Phase, 50 Hz, 30 Amp, 3 wire (including ground)  
\* Connector: **32A, 3 pin (L+N+E)** (IEC 309, EN60309)

- 380-415 VAC, 3 Phase, WYE, 15 Amp, 5 wire  
\* Connector: **32 A, 5 pin (3L+N+E)** (IEC 309, EN60309)

Convection Power In 5.2kw  
Microwave Power In 2kW

### SHIPPING INFORMATION:

Approx. Weight: Single 300 lbs.  
Crated: 334lb(152kg) w/Starter Kit 364lb(165kg)  
Uncrated: 255 lbs. (116kg)  
Double Stack 600 lbs. (272kg) 510 lbs. (231kg)  
Crate size:  
30.5" (775mm) x 34" (864mm) x 32.5" (826 mm)

NOTE: FOR COMMERCIAL USE ONLY

TC3 - 0237 Rev B 9-25-2002